

LONGITUDINAL SECTION

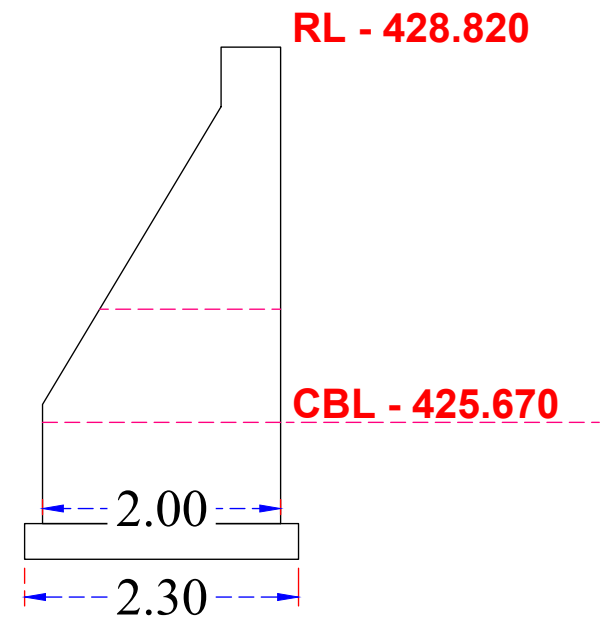

CROSS SECTION X-X

DETAIL OF TRIAL PIT SECTION

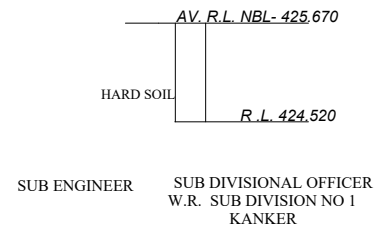

SUB ENGINEER SUB DIVISIONAL OFFICER  
W.R. SUB DIVISION NO 1  
KANKER

GOVERNMENT OF CHHATTISGARH  
WATER RESOURCES DIVISION, U.B.KANKER

DRAWING FOR RENOVATION OF SLUICE GATE OF  
SARWANDI TANK

DRAWN BY,

CHECKED BY

SUB ENGINEER

ASSISTANT ENGINEER(D)  
WATER RESOURCES DIVISION  
KANKER

CHECKED BY

APPROVED BY

SUB DIVISIONAL OFFICER  
W.R. SUB DIVISION NO 1  
KANKER

EXECUTIVE ENGINEER  
WATER RESOURCES DIVISION  
KANKER

DRG. NO.